



# FOR SUBLEASE

±16,414 SF | INDUSTRIAL WAREHOUSE UNIT

26201 YNEZ ROAD | TEMECULA, CA

## PROPERTY HIGHLIGHTS

- \$1.26/SF Gross
- 16,414 SF Industrial Warehouse Unit
- POL 100,938 SF Multi-Tenant Building
- Service Commercial Zoning (Verify)
- 2 Dock High Loading Doors
- 1 Ground Level Warehouse Door
- 24' Clear Height
- Existing Warehouse Racking & Sales/Will Call Desk Available
- Occupancy Immediately Available.



# FOR SUBLEASE

±16,414 SF | INDUSTRIAL WAREHOUSE UNIT

26201 YNEZ ROAD | TEMECULA, CA

## FLOOR PLAN

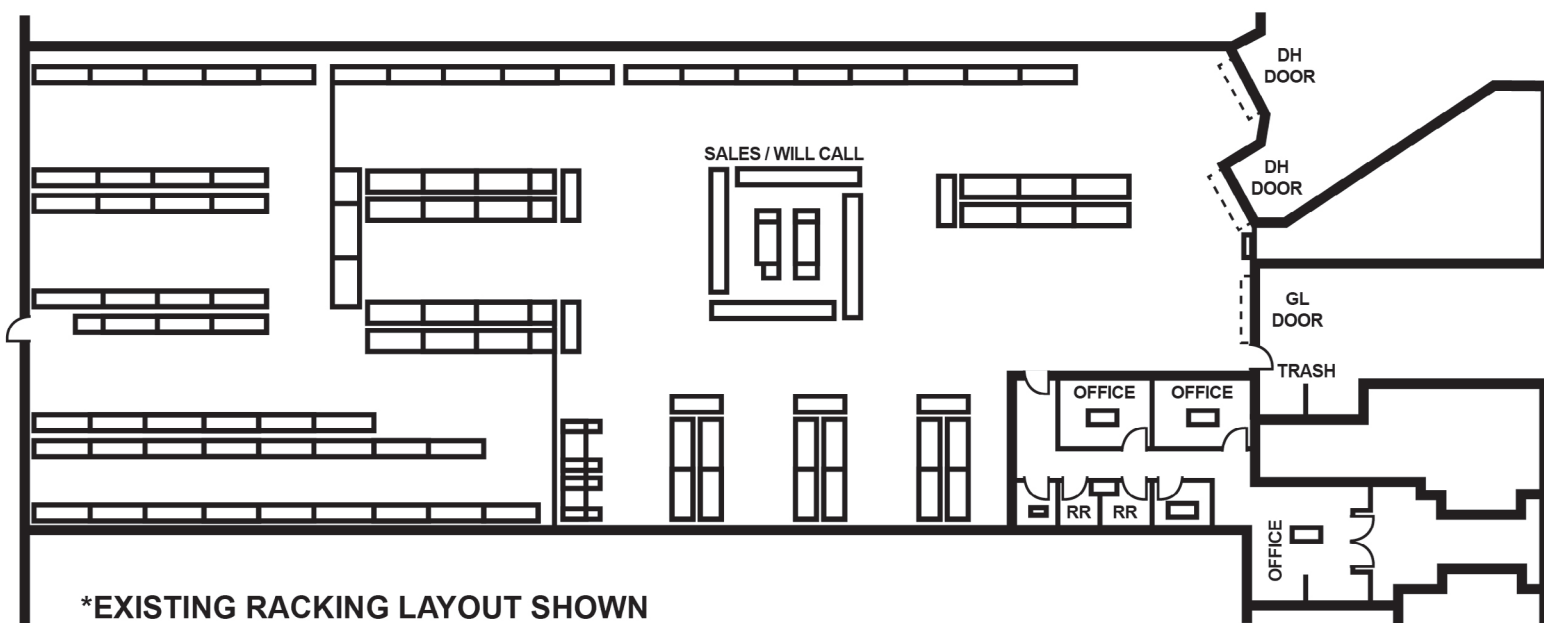

\*EXISTING RACKING LAYOUT SHOWN



\*ALL MEASUREMENTS ARE APPROXIMATE AND ARE NOT TO SCALE. MEASUREMENTS ARE INTERIOR MEASUREMENTS, FLOOR PLAN DOES NOT SHOW ALL IMPROVEMENTS.

# FOR SUBLEASE

±16,414 SF | INDUSTRIAL WAREHOUSE UNIT

26201 YNEZ ROAD | TEMECULA, CA



# FOR SUBLEASE

±16,414 SF | INDUSTRIAL WAREHOUSE UNIT

26201 YNEZ ROAD | TEMECULA, CA



# FOR SUBLEASE

±16,414 SF | INDUSTRIAL WAREHOUSE UNIT

26201 YNEZ ROAD | TEMECULA, CA



